

ANNEXURE : E
MEMO FROM WCGRB



Western Cape Gambling and Racing Board
Wes-Kaapse Raad op Dobbelaar en Wedrenne
Ibhodi Yelentshona Kapa Yokungcakaza Ngemali Neyemidyaro

Form 164-17

Page 1 of 7

Application For A Limited Gambling Machine Premises Licence

All correspondence to be addressed to

The Chief Executive Officer
P O Box 8175
ROGGEBAAL
8012
Republic of South Africa

Telephone No.: (27 21) 480-7400
Fax No.: (27 21) 422-2603
Website: www.wcgrb.co.za

For office use : Reference no. _____

Authorised signature _____



PART ONE

APPLICATION INSTRUCTIONS

1. A limited gambling machine premises licence is required for any premises in the Western Cape in or on which limited gambling machines ("LGM's") are placed by the holder of a limited gambling machine operator licence.
2. A "limited gambling machine" means a slot machine as prescribed in the Western Cape Gambling and Racing Law, 1996 (No 4 of 1996), as amended ("Law").
3. "Premises" means any site, place or location, situated on immovable property, in respect of which an application for a limited gambling machine licence is made.
4. For each application for a limited gambling machine premises licence, Parts Two and Four of this proforma must be completed and a report must be furnished in respect of the information required in Part Three.
5. The application form must also be accompanied by a certified copy of the title deed pertaining to the Premises together with a conveyancer's certificate stating that the envisaged gambling activity is not in conflict with any conditions set out in the said title deed.
6. Return the completed form with five copies to the Manager: Licensing, Western Cape Gambling and Racing Board, P O Box 8175, ROGGEBAAI, 8012 or deliver it by hand to the 8th Floor, S A Reserve Bank Building, 60 St George's Mall, Cape Town, 8001.
7. All dates must be in the format : Day / Month / Year.

Authorised signature _____



PART TWO

PARTICULARS OF APPLICANT

1 (A) Title:

Mr

Surname:

COETZER

First

WINSTON SAVILLE

names:

If a legal person, indicate nature of legal person:

OWNER

1 (E) Street address:

P.O. BOX 500
WEST BEACH

Postal code:

7449

1 (F) Postal address:

c/o REPUBLIC & JAN SMITS AVE
& OFFICE DU PRESSIS AVE

Postal code:

1 (G) Telephone number:

021 557 9774

1 (H) Fax number:

N/A

1 (I) Where the applicant is not the legal owner of the Premises, indicate the applicant's relationship to the owner and include the necessary authorisation to make application on the owner's behalf.

Authorised signature



PART THREE

PARTICULARS OF PREMISES TO BE LICENSED WITH REFERENCE TO LAND USE MATTERS

The application for each site should be accompanied by a land use planning report containing the following information:

NOTE: Applicants should ensure that the criteria identified in the licensing manual are adhered to.

1. Background Information

- 1.1 Street address;
- 1.2 Erf number;
- 1.3 Description of property as per the title deed, and
- 1.4 The name of the local authority in whose area of jurisdiction the site falls.

2. Building Floor Area Plan (Map 1)

- 2.1 Provide a Building Floor Area Plan/Diagram to a scale of not less than 1:100 and describe and indicate the following:
 - 2.1.1 the building where LGM's are to be installed;
 - 2.1.2 the number of LGM's and their location within the establishment;
 - 2.1.3 how the designated area will be made inaccessible to persons under the age of 18;
 - 2.1.4 how adequate control, other than by way of physical layout, is to be exercised to preclude persons under the age of 18 years from gaining access to LGM's;
 - 2.1.5 whether the floor space used for the LGM's is more than 25% of the floor space used for the primary activity;
 - 2.1.6 whether the machines are placed in such a manner as to provide for an unobstructed view of each LGM from the point of supervision, any mirrors necessary to maintain adequate supervision and any video surveillance equipment that will be used for supervision;

Authorised signature _____



- 2.1.7 whether the gambling area at least 3 square meters per LGM;
- 2.1.8 whether the machines are at least 2 m from the cordoned off area. If not, whether a non-transparent continuous wall of at least two metres in height is provided and the machines are at least two metres from any aperture in such wall;
- 2.1.9 whether there is a separate cordoned-off area or a restricted area as contemplated in the Liquor Act, 1989 (Act 27 of 1989) where applicable;
- 2.1.10 whether photographs are attached showing the existing interior and exterior of the premises;
- 2.1.11 whether the premises are immovable, and
- 2.1.12 whether an application for a business licence has simultaneously been lodged with the Municipality. (where three or more LGM's per site have been applied for)
- 3. Site Context (Map 2)**
- 3.1 Provide a Site Plan to the scale of 1:500, indicating the building's footprint and layout specifying parking arrangements as well as egress and access to such parking and describe the following:
- 3.1.1 the primary activity conducted on the premises;
- 3.1.2 whether such primary activity is geared towards providing leisure, recreation or entertainment;
- 3.1.3 whether the current activity on the site is lawful and whether all the required permits/licences (which must be listed) have been obtained;
- 3.1.4 whether the LGM activity is secondary to the primary activity in terms of floor space. If not, provide details;
- 3.1.5 what other activities are conducted on the site;
- 3.1.6 what signage will be displayed advertising the availability of LGM's on the site;
- 3.1.7 whether the envisaged activity is compatible with the zoning of the property as per the local authority's town planning scheme;

Authorised signature _____



- 3.1.8 whether the site falls within one of the preferred categories of primary activities as set out in paragraph 2.5.6 of the manual;
- 3.1.9 whether the site falls within one of the 'not preferred' sites as set out in paragraph 2.5.7 of the manual (including house shops) and, if so, which one. Motivate in full why it is deemed appropriate to conduct a gambling activity on this site, and
- 3.1.10 whether the premises can link up with the Central Monitoring System.
4. Surrounding Context Plan (Maps 3, 4, 5 and 6)
- 4.1 Attach Surrounding Context Plans (or a composite plan) to the scale of 1:5000 Indicating the position of the site as well as the following:
- 4.1.1 *Council Zoning Scheme* within a radius of 300 m;
- 4.1.2 *Existing Land Uses* within a radius of 300 meters, and
- 4.1.3 *Public and Social Facilities*; including places of worship within a radius of 200 m (in regions other than the metropolitan area) or a radius of 100 m (for applications in a metropolitan area); the location of children's playgrounds, pension payout points and schools or other institutions of primary or secondary learning. Describe and discuss the positive and negative influences of the LGM premises on these public and social facilities;
- 4.2 Attach a *Site Location Plan* showing any physical features (roads, railway lines, etc.) or natural/topographical features (rivers, hills, etc.) that could have an influence on site. Give details and show them on the plan that is on a scale of 1:10 000.
- 4.3 In respect of (a) the metropolitan area, is the site more than 500 m away from any other gambling premises or (b) a region, is the site more than 1km away from any other gambling premises?

SUPPLEMENTARY INFORMATION REQUIRED

The Board reserves the right to request the submission of additional information, plans or other documents at its discretion.

Authorised signature _____



- 3.1.8 whether the site falls within one of the preferred categories of primary activities as set out in paragraph 2.5.6 of the manual;
- 3.1.9 whether the site falls within one of the 'not preferred' sites as set out in paragraph 2.5.7 of the manual (including house shops) and, if so, which one. Motivate in full why it is deemed appropriate to conduct a gambling activity on this site, and
- 3.1.10 whether the premises can link up with the Central Monitoring System.
- 4. Surrounding Context Plan (Maps 3, 4, 5 and 6)**
- 4.1 Attach Surrounding Context Plans (or a composite plan) to the scale of 1:5000
Indicating the position of the site as well as the following:
- 4.1.1 *Council Zoning Scheme* within a radius of 300 m;
- 4.1.2 *Existing Land Uses* within a radius of 300 meters, and
- 4.1.3 *Public and Social Facilities*, including places of worship within a radius of 200 m (in regions other than the metropolitan area) or a radius of 100 m (for applications in a metropolitan area); the location of children's playgrounds, pension payout points and schools or other institutions of primary or secondary learning. Describe and discuss the positive and negative influences of the LGM premises on these public and social facilities.
- 4.2 Attach a *Site Location Plan* showing any physical features (roads, railway lines, etc.) or natural/topographical features (rivers, hills, etc.) that could have an influence on site. Give details and show them on the plan that is on a scale of 1:10 000.
- 4.3 In respect of (a) the metropolitan area, is the site more than 500 m away from any other gambling premises or (b) a region, is the site more than 1km away from any other gambling premises?

SUPPLEMENTARY INFORMATION REQUIRED

The Board reserves the right to request the submission of additional information, plans or other documents at its discretion.

Authorised signature _____



PART FOUR

APPLICATION FOR A LIMITED GAMBLING MACHINE PREMISES LICENCE

AFFIDAVIT

I, WINSTON LAMILLE COETZER
(Full names)

hereby:

- (a) declare that I have taken cognisance of and understand the rights and duties pertaining to the licence applied for, as set out in the Western Cape Gambling and Racing Law, 1996 (Law 4 of 1996), as amended, and the Western Cape Gambling and Racing Regulations, 1997;
- (b) declare that I am the Applicant identified in this form or, where the Applicant is a legal person, I have been duly authorised to make this application on behalf of the Applicant;
- (c) declare that I have personally completed this form and have supplied all the information indicated herein, and
- (d) certify that the particulars contained herein are true and correct in every detail and that I have fully disclosed the information required in completing this form.

Signed at BLONBERG on this _____ day of _____ 20____

[Signature]
(Signature)
(who warrants his/her authority)

To be signed and certified as true and correct in the presence of a Commissioner of Oaths.

Signature _____

Date: _____

Authorised signature _____

[Signature]

Western Cape Gambling and Racing Board

Site Context - The Brazen Head

A. 3.1.1

The primary activity conducted on the premises are as follows: on consumption liquor sales

B. 3.1.2

Whether such primary activity is geared towards providing leisure, recreation or entertainment ;
Geared towards providing social recreation & leisure

C. 3.1.3

Whether the current activity on the site is lawful and whether all the required permits / licenses have been obtained. Yes, the current activity on the site is lawful and has all the necessary licenses
Business licence number:
Liquor licence number: 041514

D. 3.1.4

Whether the LGM activity is secondary to the primary activity in terms of floor space. If not, provide details:- Yes

E. 3.1.5

What other activities are conducted on the site; DSTV for viewing sporting events

F. 3.1.6

What signage will be displayed advertising the availability of LPM's on the site;
Internal/External signage

G. 3.1.7

Whether the envisaged activity is compatible with the zoning of the property as per the local authority's town planning scheme; Yes

H. 3.1.8

Whether the site falls within one of the preferred categories of primary activities as set

out in paragraph 2.5.6 of the manual; Yes

I. 3.1.9

Whether the site falls within one of the 'not preferred' sites as set out in paragraph 2.5.7
No

J. 3.1.10

Whether the premises can link up with the Central Monitoring System. Yes

ANNEXURE: L FLOOR LAYOUT PLAN

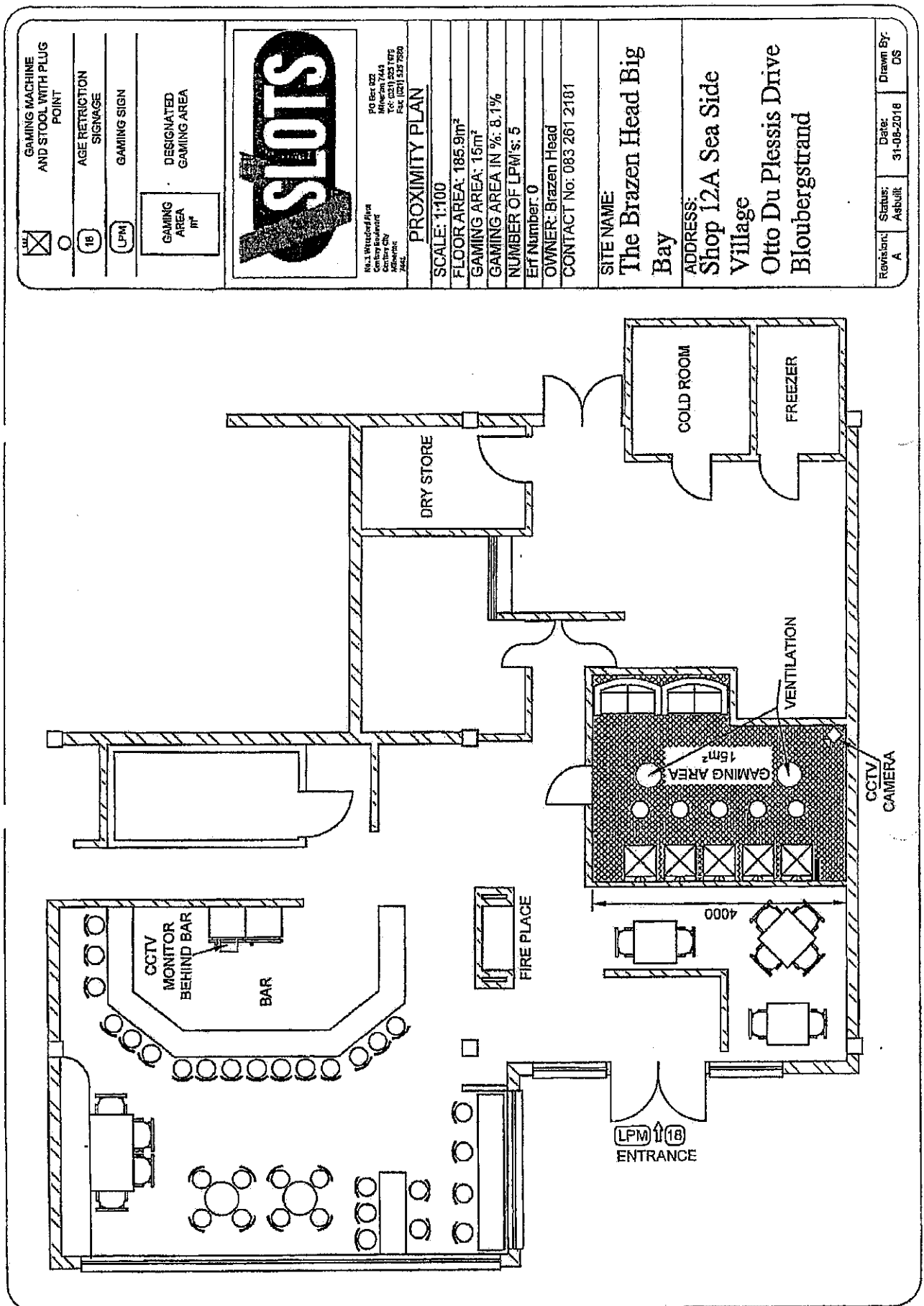



CITY OF CAPE TOWN
ISIXEKO SASEKAPA
STAD KAAPSTAD

ENVIRONMENTAL HEALTH

Marion Penman
Business Licence Officer

T: +27 21 650 7563 F: +27 21 650 7623
E: marion.penman@capetown.gov.za

CONSENT FORM

APPLICATION FOR HEALTH FACILITIES OR ENTERTAINMENT LICENCE IN TERMS OF SCHEDULE 1 OF THE BUSINESSES ACT NO.71 OF 1991.

In providing the required information, I acknowledge and consent to its use for the following purposes:

1. All information provided will be used for the purpose of determining the suitability of the Applicant and to assess all matters relevant to this application.
2. The information may accordingly be shared or disclosed to all parties and institutions in the course of the business license application process and in consideration of the application.
3. This application and supporting documentation are considered by Sub-Councils at a meeting that is open to the public and the media.

I, (print name)..... BRANDON FRANKS the undersigned, confirm that I have read and understood the contents of this Application and as contained above.

.....
Signature of Applicant

Date..... 17/04/17

AGENT
.....
Capacity of Applicant

<http://Citymystles.CapeTown.Gov.Za/Personal/MyPenman/Personal Documents/Novel1 LICENCE REPORTS TO COUNCIL/TEMPLATES/CONSENT FORM FOR APPLICANT.Docx>

ROYAL ASCOT BLOCK A FIRST FLOOR
BRIDLE WAY MILNERTON 7441 PO BOX 35 MILNERTON 7435
www.capetown.gov.za

Making progress possible. Together.